



DALES & PEAKS

**38 Hackney Road**  
Hackney, Matlock, DE4 2PX  
**£1,375 PCM**





## 38 Hackney Road

Hackney, Matlock, DE4 2PX

A beautifully presented three-bedroom semi-detached property, set in an elevated position that boasts breathtaking views of the surrounding countryside. With 952 sq ft of well-appointed living space, the home also features front and side gardens, as well as off-street parking to the rear.

The ground floor includes a welcoming living room with a log-burning stove set on a stone hearth, an open-plan dining kitchen with under-stairs storage, and a garden room with patio doors leading to the front garden.

Upstairs, the property offers three generously sized bedrooms, each with front-facing windows that make the most of the exceptional views. The family bathroom is fitted with a bath and overhead shower.

### Rental information







Floor Plan

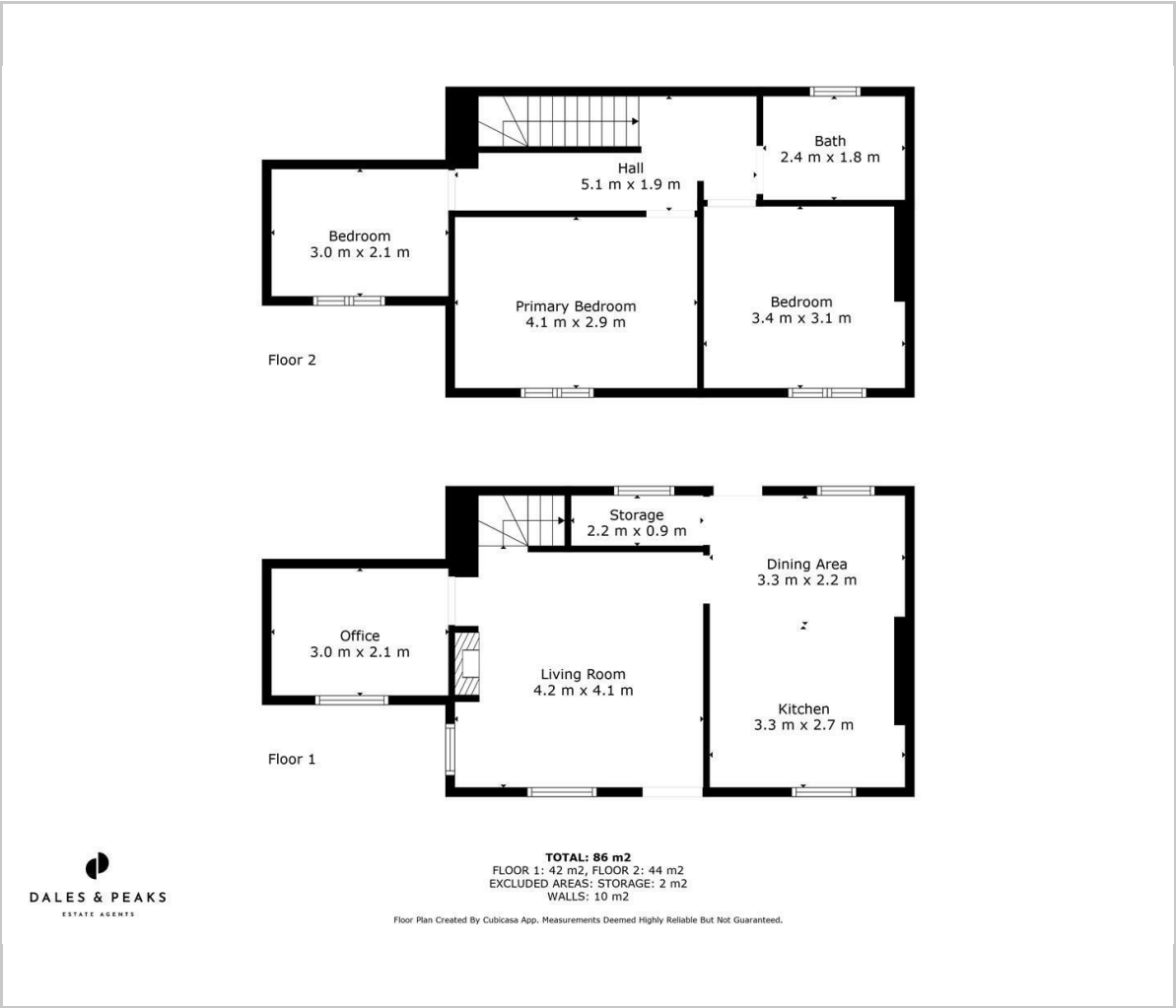

Viewing

Please contact our Matlock Office on 01629 700246 if you wish to arrange a viewing appointment for this property or require further information.

These particulars, whilst believed to be accurate are set out as a general outline only for guidance and do not constitute any part of an offer or contract. Intending purchasers should not rely on them as statements of representation of fact, but must satisfy themselves by inspection or otherwise as to their accuracy. No person in this firms employment has the authority to make or give any representation or warranty in respect of the property.

Area Map



Energy Efficiency Graph

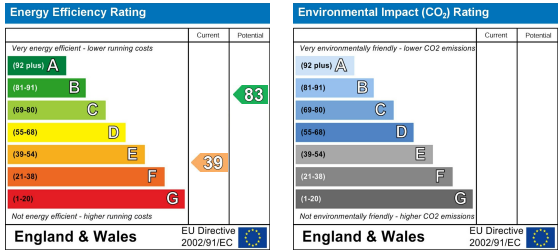

2 Dale Road, Matlock, Derbyshire, DE4 3LT  
T: 01629 700246



E: info@dalesandpeaks.co.uk  
www.dalesandpeaks.co.uk